

Mac Users follow the onscreen pop-ups in order as shown below. Download the Mac file to your desktop then double click to extract the installer.app file.

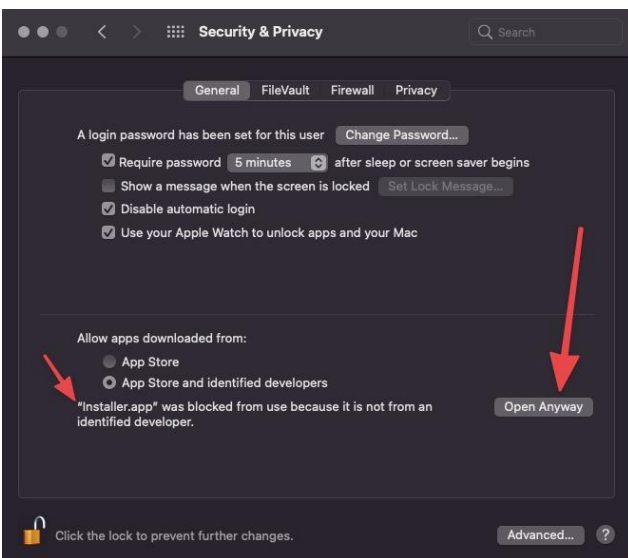
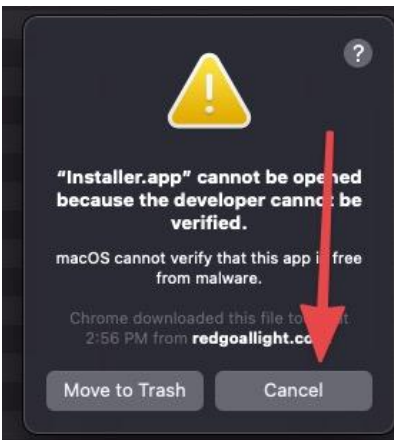
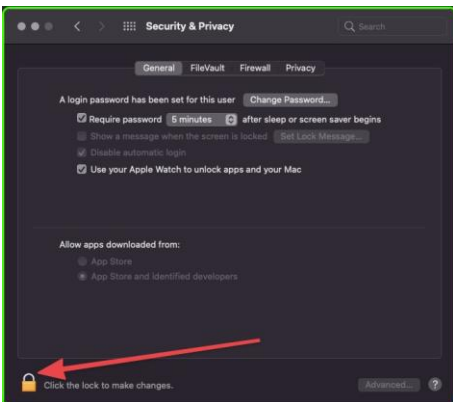
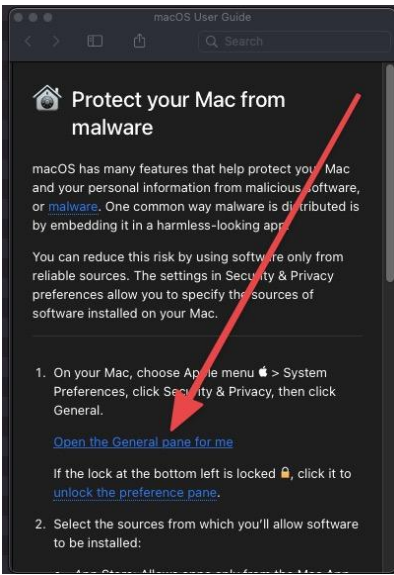
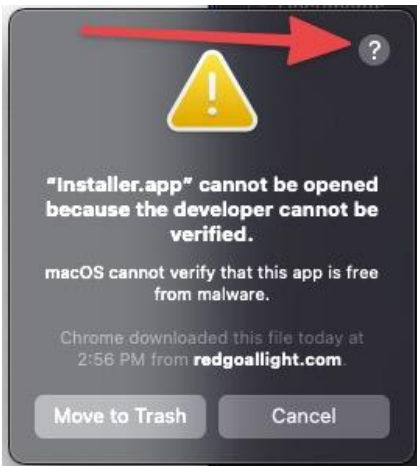

```
1* $ python3 uploader.py
/dev/cu.usbserial-1440-Incoming-Port
/dev/cu.usbserial-1440
Target COM port found -> /dev/cu.usbserial-1440
/dev/cu.usbserial-1440
esptool v0.4.13 - (c) 2014 Ch. Klippel <ck@atelier-klippel.de>
opening port /dev/cu.usbserial-1440 at 921600
warning: serialport_set_baudrate: baud rate 921600 may not work
opening bootloader
resetting board
trying to connect
trying to connect
Uploading 1824000 bytes from D1.spiffs.bin to flash at 0x00300000
..... [ 8% ]
..... [ 16% ]
..... [ 24% ]
..... [ 32% ]
..... [ 40% ]
..... [ 48% ]
..... [ 56% ]
..... [ 64% ]
..... [ 72% ]
..... [ 80% ]
..... [ 88% ]
..... [ 96% ]
..... [ 100% ]
Uploading 445504 bytes from D1.ino.d1.bin to flash at 0x00000000
..... [ 10% ]
..... [ 20% ]
..... [ 30% ]
..... [ 40% ]
..... [ 50% ]
..... [ 60% ]
..... [ 70% ]
..... [ 80% ]
..... [ 90% ]
..... [ 100% ]
starting app without reboot
closing bootloader
```